

零配件

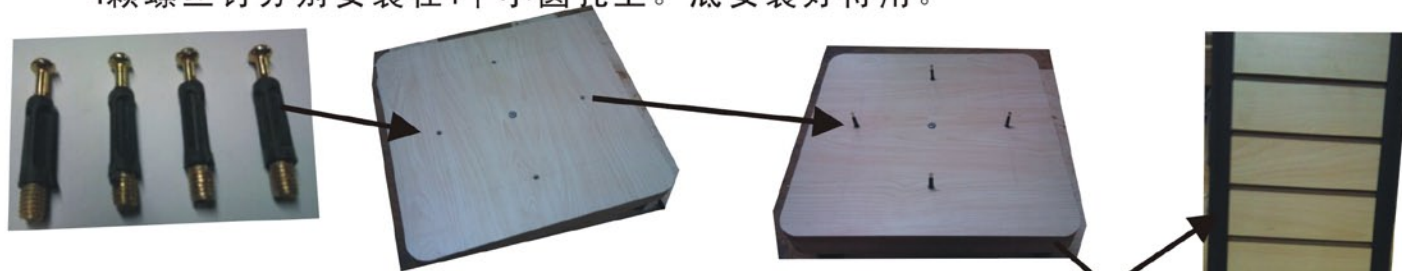

1.底部安装程序

4颗螺丝钉分别安装在4个小圆孔上。底安装好待用。



2.身体部分安装程序

4条塑料条分别安装在4块木板的4个角上如下图所示。

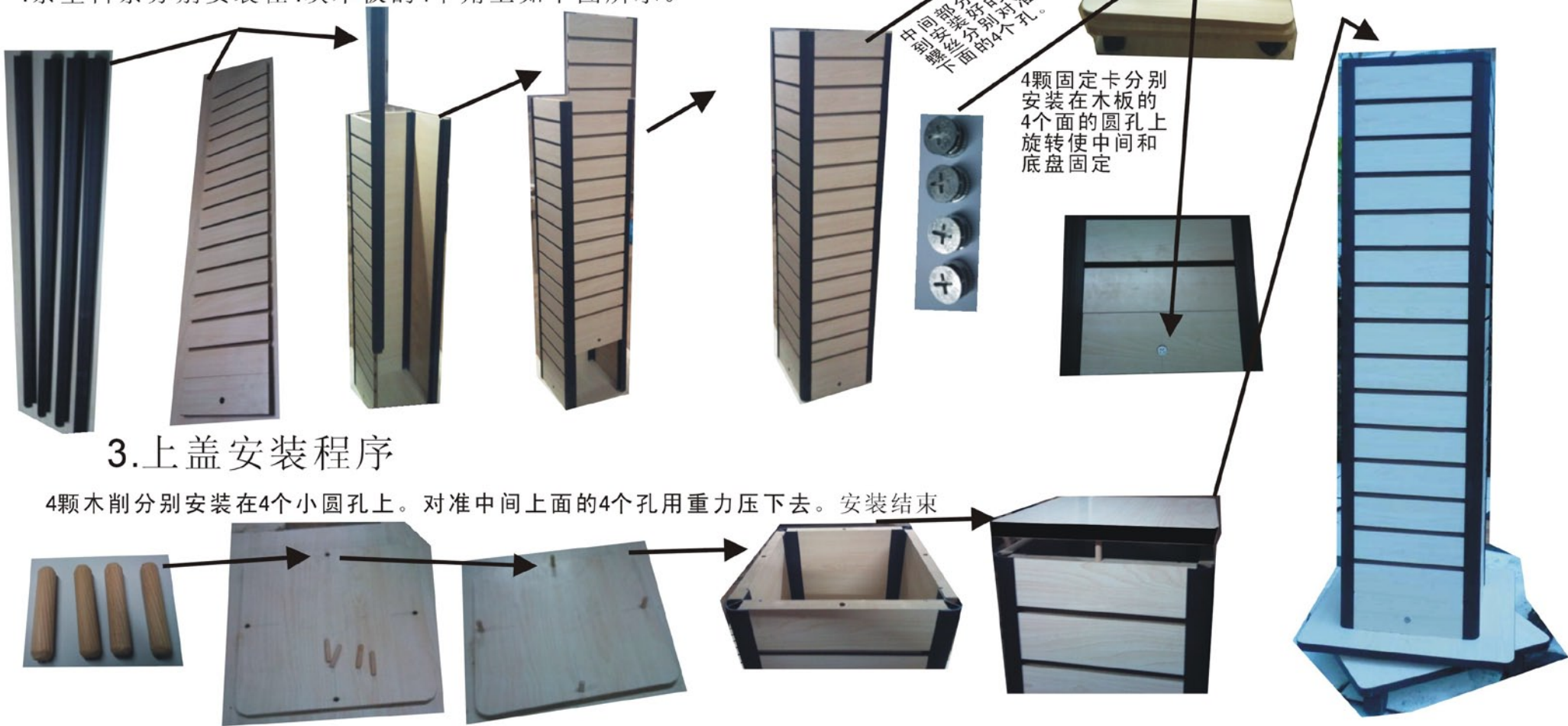

4条塑料条分别安装在4块木板的4个角上如下图所示。

4颗固定卡分别安装在木板的4个面的圆孔上旋转使中间和底盘固定

3.上盖安装程序

4颗木削分别安装在4个小圆孔上。对准中间上面的4个孔用重力压下去。安装结束

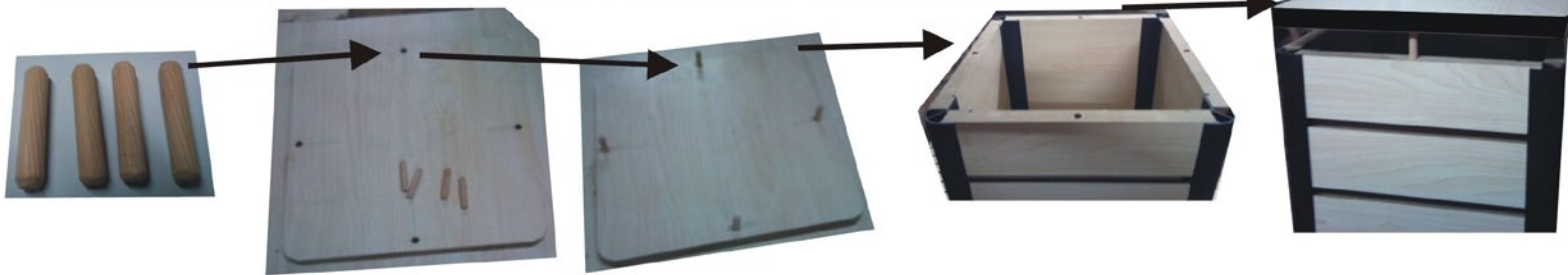

Parts



1. The base of the display

4 screws are installed into 4 small round holes. Completed base stand.

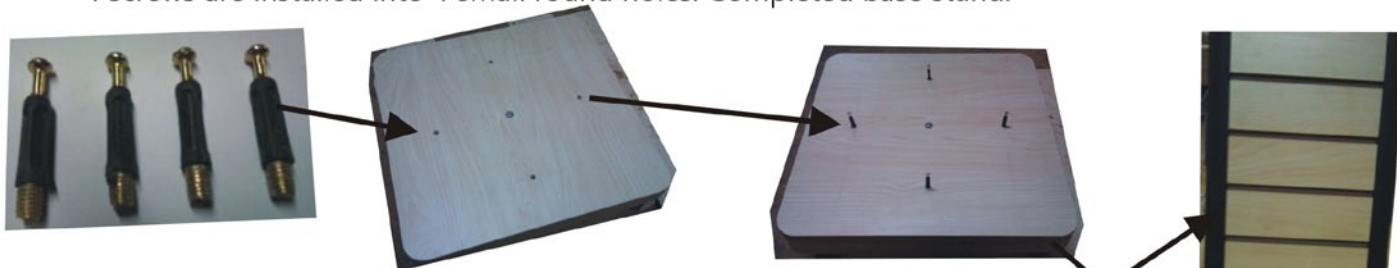

2. Assembly of the body

4 plastic strips are installed onto 4 corners of wood uprights as shown below.

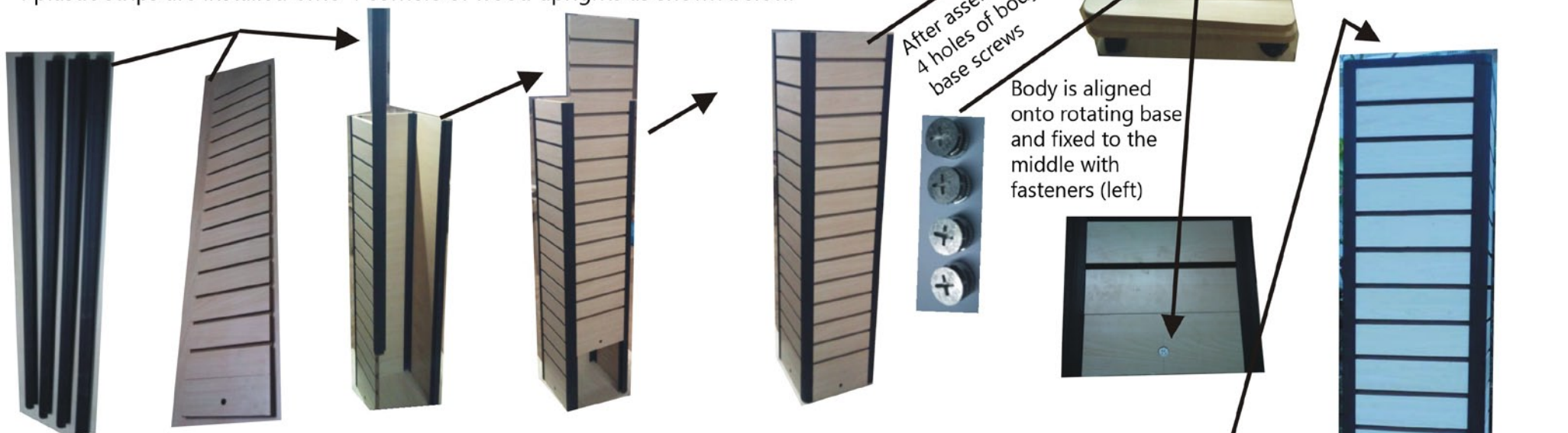

After assembly align 4 holes of body onto base screws

Body is aligned onto rotating base and fixed to the middle with fasteners (left)

3. Roof assembly

Install 4 round dowels into holes. Align dowels onto the 4 holes of the body press down hard.

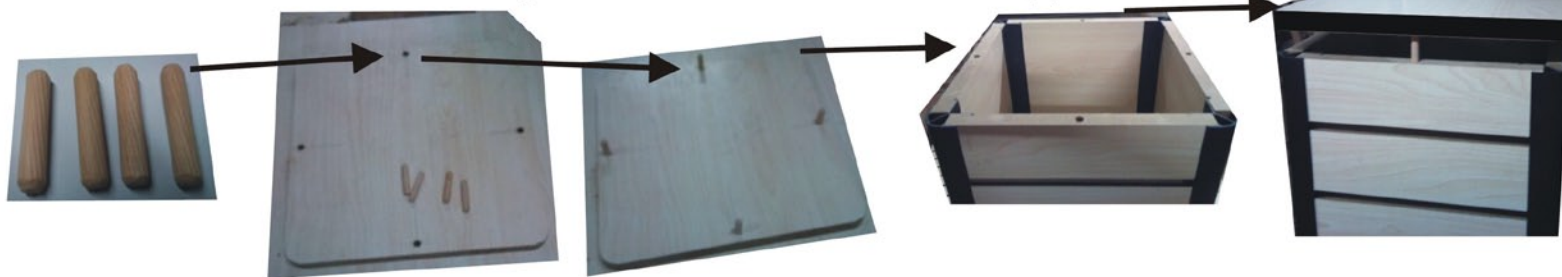

End of assembly.